

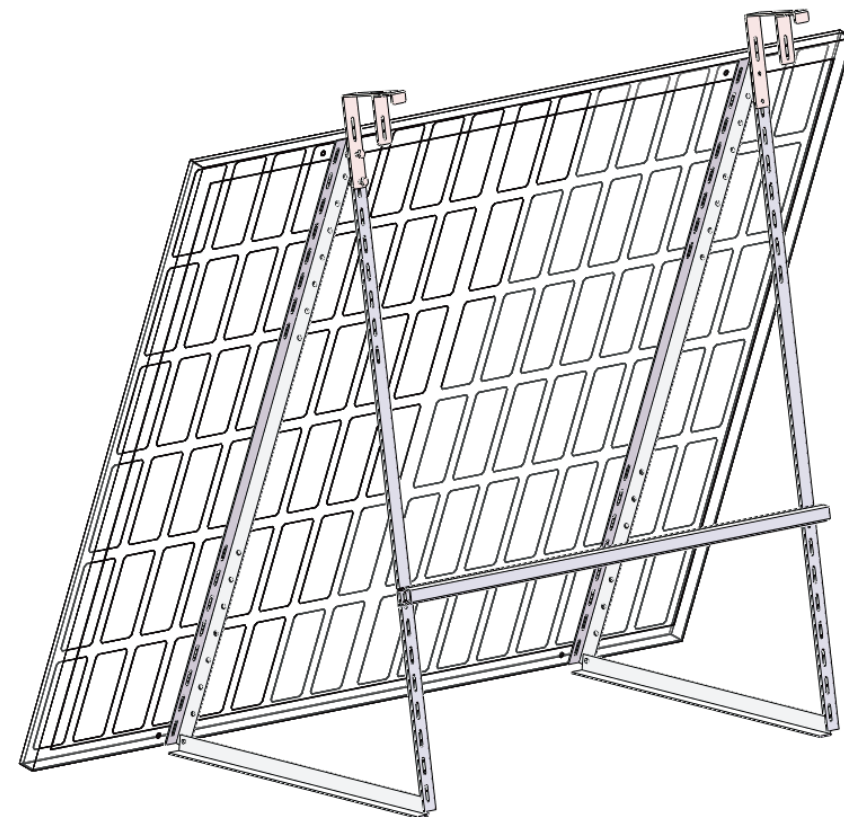

Yuncheng Solar Technology Co., Ltd

16/F, Block A1, Wuxi IC Design Center, 777 West Building Road, Binhu District, Wuxi City,
Jiangsu Province, P.R. China
Tel: +86 510 8595 9369 | Email: info@thornovasolar.com | Web: www.thornovasolar.com



INSTALLATION GUIDE

Solar panel mounting brackets for balcony

1.Tools for Installation



Open-end wrench 13mm



Open-end wrench 10mm

2.Components of The System

Serial no.	Designation	Image	Size	Quantity
1	Solar panel		1722 x 1134 x 30mm	1
2	Aluminum profile		1135mm	4
3	Rail connector		525mm	2
4	Crossbar		1110mm	1
5	M8 screw		M8x20	6
6	M6 screw		M6x20	2
7	M8 screw (For Micro inverter)		M8x20	1
8	M6 x 90mm screw		M6x90	2
9	M6 x 20mm screw		M6x20	10
10	Railing hook	 Screws are included in the accessories	160*110*2.6mm	2
11	Rubber mat		195x35mm	2

3. Angle Adjustment

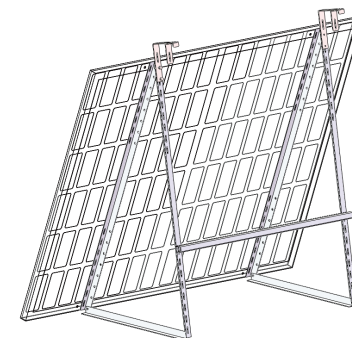
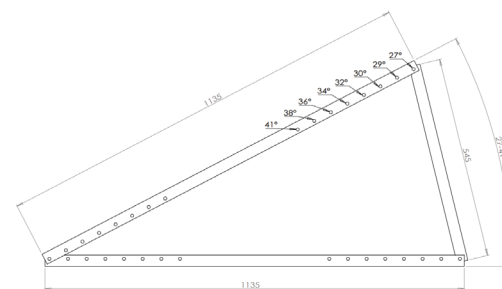

Scheme of hook fastening on the balcony with adjustable angle from 27 ° to 41 °.

4.Installation Instruction

4.1 Mounting the aluminum profiles on the solar panel

First, please connect the vertical profiles with the provided holes on the solar panel.

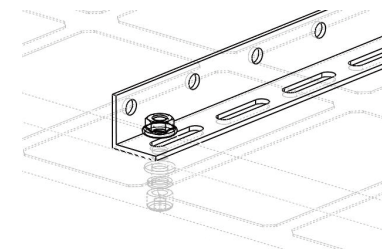
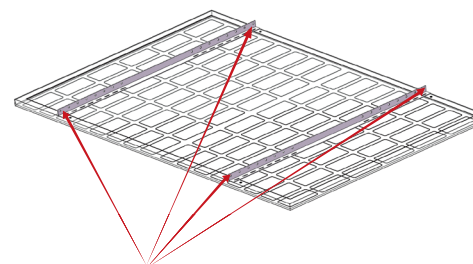

4 times M6×20 with one gasket

4.2 Mounting the triangular bracket

Use M8 screws to connect the triangular bracket. The suspension angle of the PV module can be adjusted through different holes.

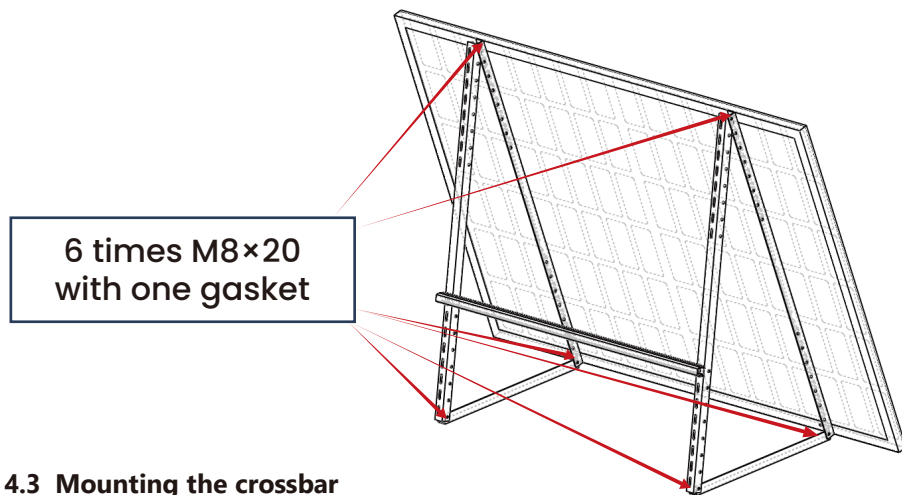

4.3 Mounting the crossbar

The crossbar gives the additional stability of the substructure and is usually used to mount the micro-inverter directly. When doing so, observe the required cable lengths.

Depending on your local requirements, you can mount the crossbar in different positions

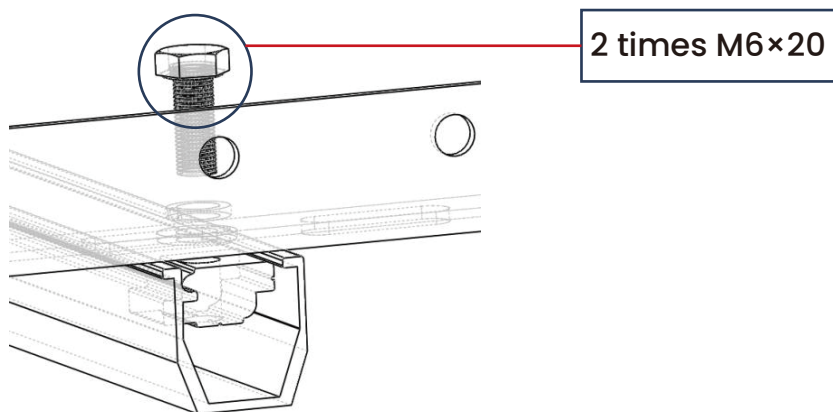

4.4 Installation of microinverters

Please use M8 screws (For Micro inverter) on the crossbar to fix the inverter.

4.5 Mounting the railing hooks

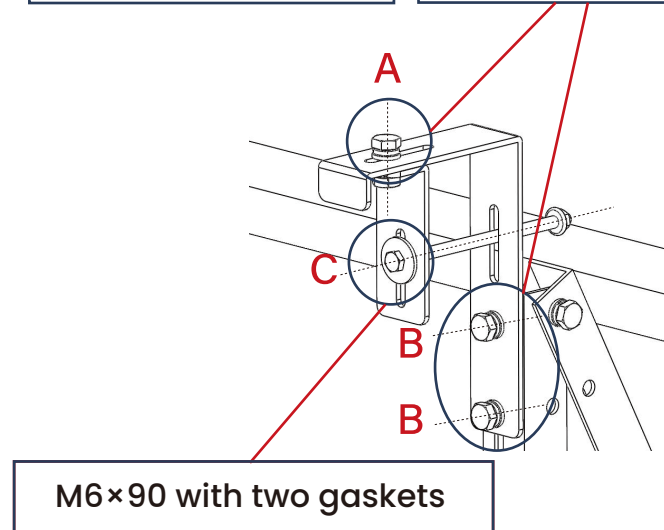
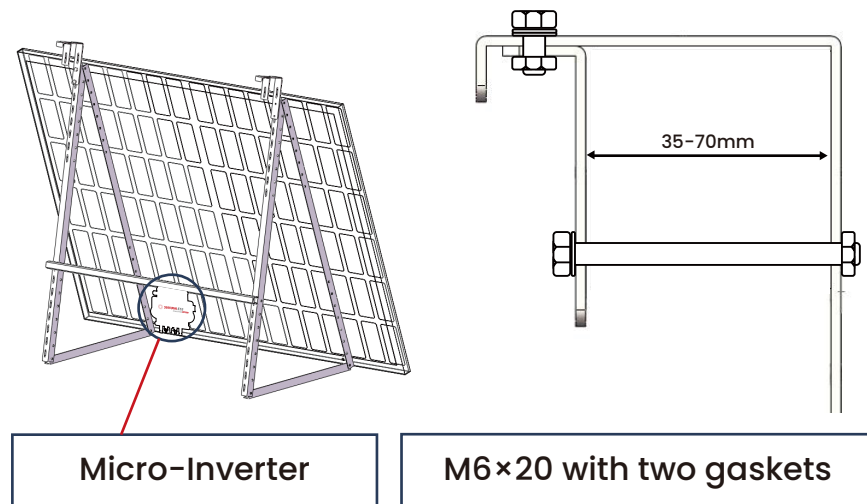

- a. Place the hook on the railing, adjust the bar diameter and lock the bolt at A.
- b. Connect the hook to the triangular bracket by screw at B.
- c. Hang the bracket on the railing (two persons are required to work on it).
- d. Attach the hooks to the railing with the screw at C.

5. Notes

- a. These installation instructions are intended exclusively for this product.
- b. It is essential to follow the sequence of steps.
- c. Do not perform the electrical installation until the assembly is complete.
- d. Any type of modification to the mounting kit will void the warranty.
- e. Please do not mount the PV panels vertically.
- f. Please wear gloves during installation.